

WE'RE ALL IN THIS TOGETHER . . . LITERALLY

**IF YOU SEE SOMETHING
SUSPICIOUS OR UNUSUAL,
SAY SOMETHING!**

**TELL YOUR CONDUCTOR OR:
CALL AMTRAK®POLICE: 800-331-0008,
TEXT APD11 (27311) OR DIAL 911**

Please have your train number when
making a report

Customer Safety Instructions

PLEASE DO NOT REMOVE THIS CARD FROM THE TRAIN

For customer service questions,
please call: 800-USA-RAIL

Scan this code with your Smartphone to
watch the "Passengers for Amtrak Safety
and Security" video



Amtrak  **CASCADES®**
SERIES 8

 **AMTRAK®**

For Your Traveling Safety

At the Station

- Arrive early to avoid rushing to your train.
- Where available, seek Amtrak® Red Cap assistance with luggage if necessary.
- Use caution at all times while walking on station platforms. Always hold hands of young children traveling with you.
- While waiting on station platforms, never allow or encourage children to play near or on railroad tracks.
- Always stand well behind the yellow safety lines as trains approach the platform.
- Be alert and watch for moving carts and vehicles on the platform.
- Use caution when boarding or exiting the train, the distance between the platform and train may vary from station to station. Handrails on either side of the door are there to assist you. Also, please assist children on and off the train.
- Never leave children, luggage, or packages unattended.

On the Train

- Never enter or exit a moving train.
- Always use the handrails to assist you when boarding the train. Be prepared for train motion by using seat backs, luggage racks, and internal handrails for support while moving through the train.
- Once on board, always wear shoes when walking. Be especially careful when wearing light-weight shoes, or shoes without rubber soles.
- Do not leave tripping hazards, such as luggage, in the aisles or vestibules. Ask for

STAIRS



Use the handrails on stairs.

WATCH STEP



Watch your step carefully between the train and the platform, and assist children when doing so.

assistance if you need help to lift your luggage into the overhead bins.

- Watch your hands, fingers, and knees when lowering and raising seat back trays and conference tables, and while passing between cars and automatic doors.
- No smoking is permitted — including in the rest rooms.

For Assistance

- If you do not understand any of these safety instructions, need help or have questions, please feel free to ask any Customer Service Representative.

Emergency Exits

In an emergency listen for directions from the train crew.

A. First Choice - End Doors

1. If no instructions are given walk to the next car.
2. Press red button (above) and slide door open.

B. Second Choice - Side Doors

If the train is stopped and the next car is blocked use the side doors to exit the train.

1. First push green "Open" button and wait 5 seconds.
2. If door does not open, brake glass and press red button.
3. Pull up large red handle.
4. Push door out and slide to open.

C. Third Choice - Emergency Windows

If the train is stopped and no other exits are available designated windows may be used as emergency exits.

1. Locate the red plastic handle on the window. Pull the red handle up and toward you.
2. Pull off gasket.
3. Remove glass with metal handle.
4. Place glass next to seat and exit.

Caution: Window weighs 77lbs

A First Choice - End Doors

Move through doors to next car.

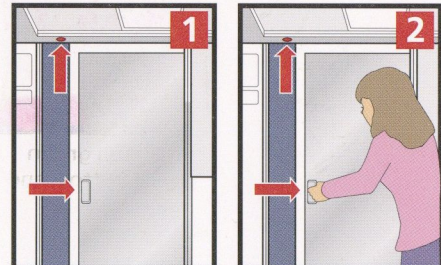

Walk to the next car first. Press red button (above) and slide door open.

Business Class and Coach Cars

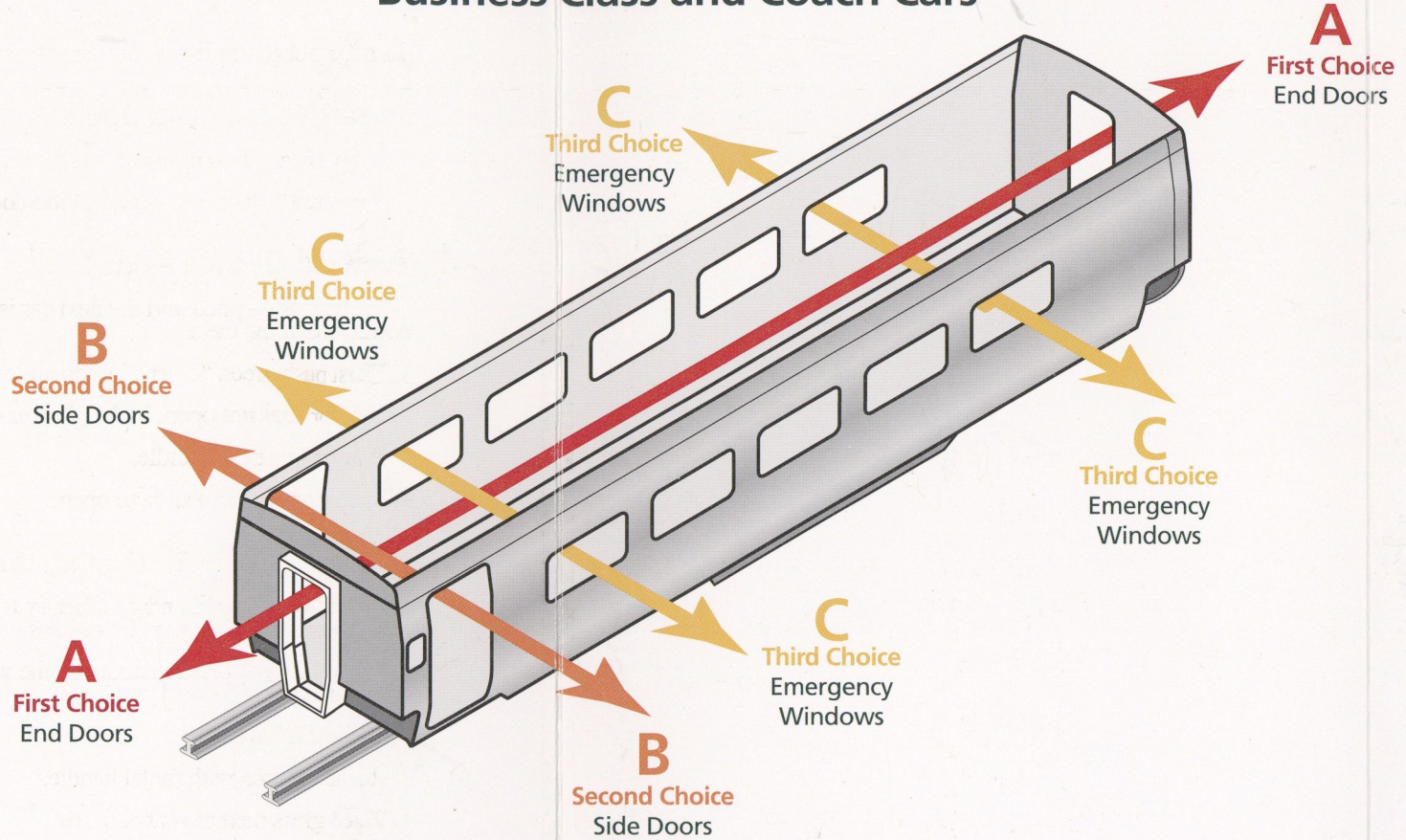

B Second Choice - Side Doors

If the train is stopped and the next car is blocked use the side doors to exit the train.

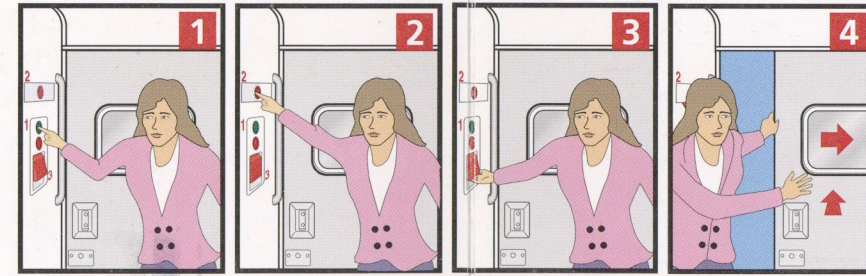

First push green "Open" button and wait 5 seconds. If door does not open, break glass and press red button. Pull up large red handle. Push door out and to the side.

C Third Choice - Emergency Windows

If the train is stopped and no other exits are available designated windows may be used as emergency exits.

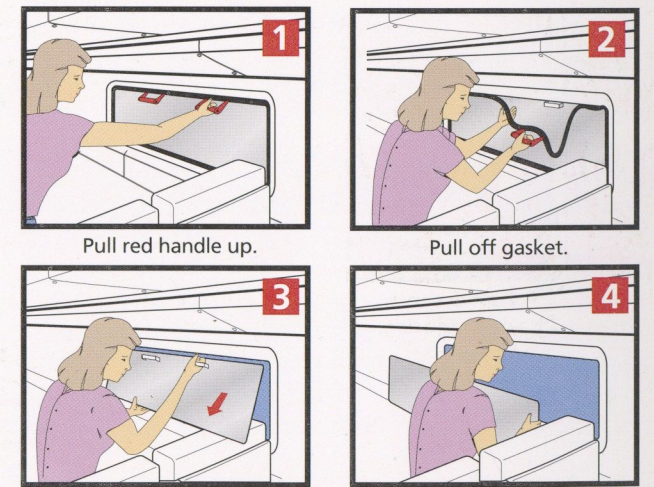

Pull red handle up. Pull off gasket. Remove glass with metal handle. Place glass next to seat and exit.

AVOID

- Fires
- Smoke
- Debris or Obstructions
- Leave Luggage Behind

WARNING! Never exit from a moving train.

Caution: Window weighs 77 lbs.



In an Emergency

1. Never exit a moving train.
2. Assess conditions. If there is no immediate danger, await instructions from a crew member.
3. When there is immediate danger and no crew members are available:
 - A.** Go to the next car.
If the route is blocked,
 - B.** Exit the train through the side doors in the vestibule.
If there are no other exits available,
 - C.** Exit through an Emergency Exit Window.
4. Move clear of train and at least 15 feet away from any tracks. Stay together in groups, and do not leave the scene.



Hazards

Before exiting the train, determine if there are any hazards, such as:

- Fire or smoke
- Debris
- Downed electrical wires
- Oncoming trains

Leave luggage behind.

Be careful of steep drops, difficult terrain, and/or water.

Do not leave the train when inside a tunnel or on a bridge unless directed to do so.



Emergency Lighting

- In the event of a power failure, battery power will illuminate overhead lights.
- Chemical "Snaplights" are provided in the Emergency Equipment locker at the rest room end of each car. To activate:
 1. Just bend once,
 2. Snap,
 3. Shake.

Emergency Intercom

To contact crew member in the event of an emergency:

- Locate nearest passenger intercom panel
- Press Call button
- Wait for communication to be established with the crew member

WE'RE ALL IN THIS TOGETHER . . . LITERALLY

IF YOU SEE SOMETHING SUSPICIOUS OR UNUSUAL, SAY SOMETHING!

TELL YOUR CONDUCTOR OR:
CALL AMTRAK®POLICE: 800-331-0008,
TEXT APD11 (27311) OR DIAL 911

Please have your train number when
making a report

Please make note of these
emergency signs on the train:



Amtrak is a registered trademark of the National Railroad Passenger Corporation

5000003505

REVISION B 2014

Please do not remove this card from the train